

Pump Check

The RMSpumptools Pump Chek is a flapper style check valve that is used to isolate the ESP from fluid and solid fall-back upon ESP shut down. The metal-to-metal seal ensures a pressure seal against fluid fall-back when the ESP is deactivated. When pumping, the flapper sits out of the fluid flow path to provide full bore ID.

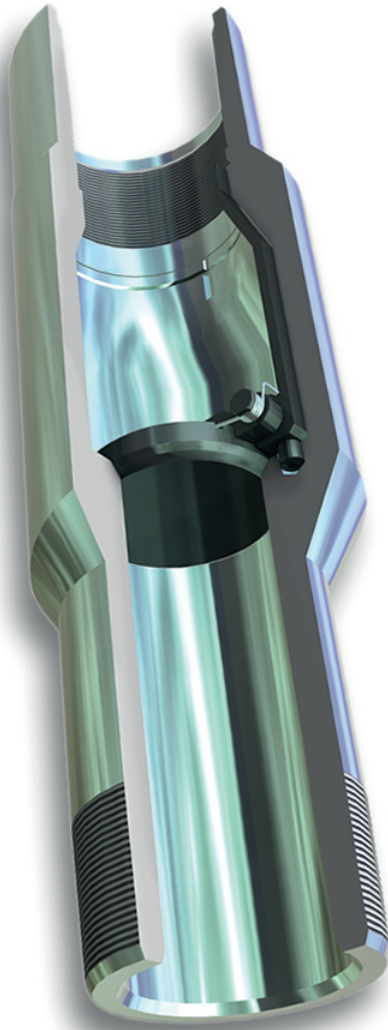

The Pump Check incorporates a Drain Feature that is activated to avoid pulling a wet string. This is provided by a burst disk in the flapper which is activated by over-pressuring the tubing string. A drop-bar is not required.

In a dual ESP completion where no lower Y-Tool is used, the Pump Chek replaces the standard NRV above the lower ESP to allow tubing drain-off before pulling (when a lower Y-Tool is used, drain-off is either automatic, or can be achieved by pulling a plug).

The Pump Chek is also used to allow pressure testing of production tubing and the setting of hydraulically operated tools such as packers.

Production Tubing	OD (Eccentric)	Bore
2-3/8" EUE	3.50"	1.87"
2-7/8" EUE	4.25"	2.25"
3-1/2" EUE	5.00"	2.75"
4-1/2" EUE	6.10"	3.50"

Burst Ratings: 1,000 - 4,000 psi

Features

- Full flow on ESP operation
- All metal pressure sealing
- No Elastomers
- Simple 1-Piece Body Construction
- Available in Alloy Steel for standard service and 13% Chrome for sour service

To Order

- Pressure Setting
- Thread Size
- Material Type

